



Professional
to
create high-quality switches
专业缔造高品质开关产品

Rocker Switch

船型开关



www.chinadaier.com





WPC-1510

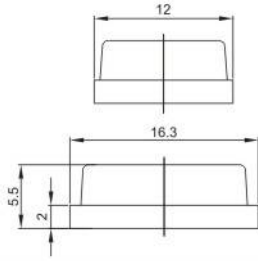

KCD5-303-1 SPST
KCD5-303-2 DPST

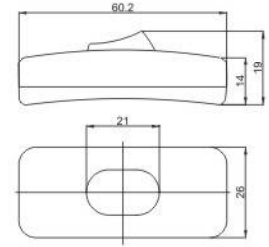

KCD5-2-101 ON-OFF

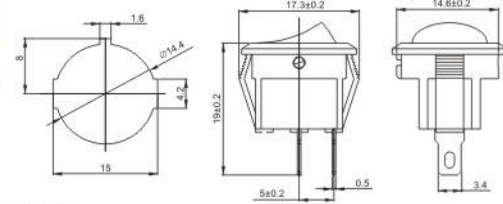

KCD5-304

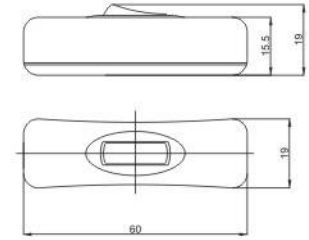

KCD5-2-102 ON-ON

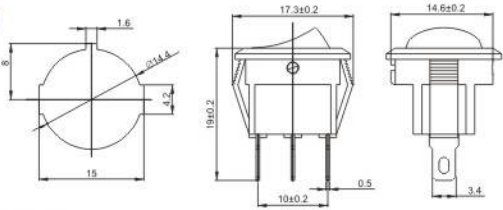

8S.304

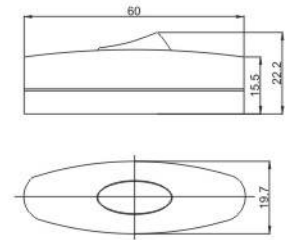

KCD5-2-101N ON-OFF

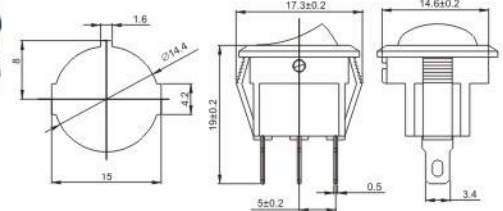

KCD5-305

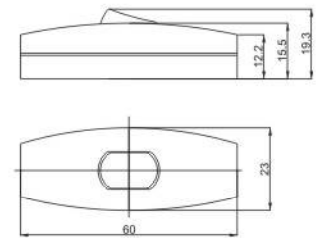

WPC-16

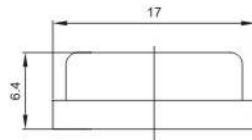

KCD5-322

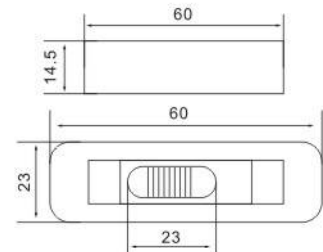

KCD5-3-101 ON-OFF

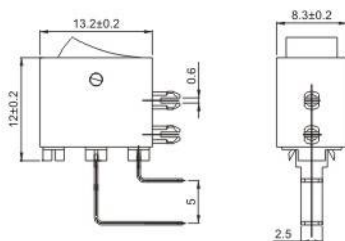

KCD5-307

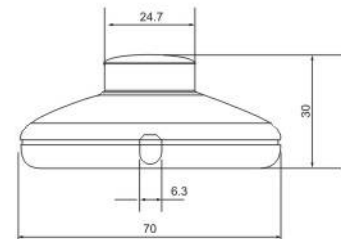

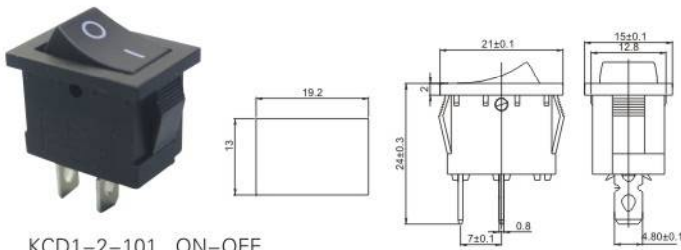

KCD1-2-101 ON-OFF
KCD1-2-111 OFF-(ON)

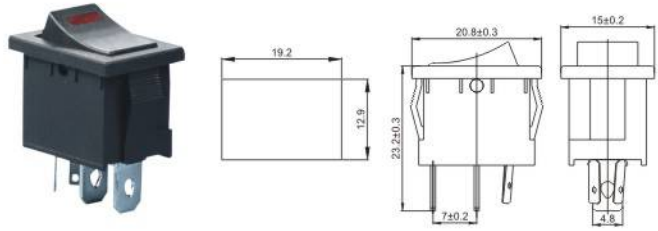

KCD1-3-101EN ON-OFF (3V LED)

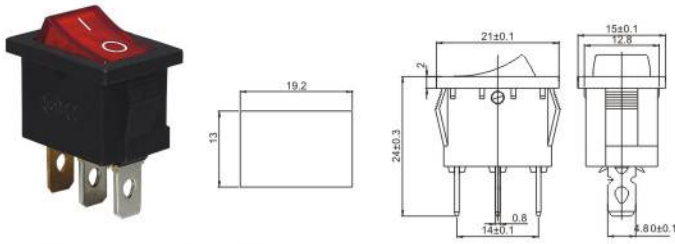

KCD1-2-101N ON-OFF

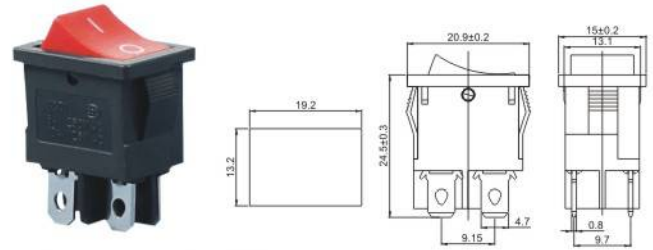

KCD1-4-201 ON-OFF

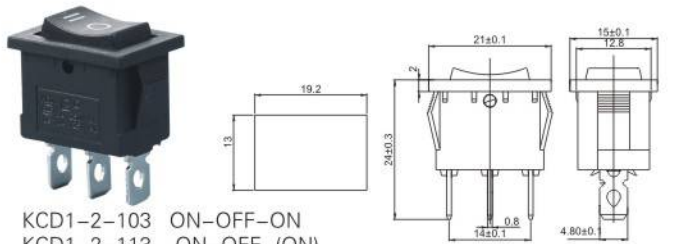

KCD1-2-103 ON-OFF-ON
KCD1-2-113 ON-OFF-(ON)
KCD1-2-123 (ON)-OFF-(ON)

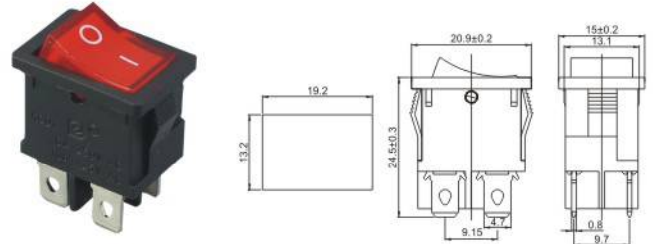

KCD1-4-201N ON-OFF

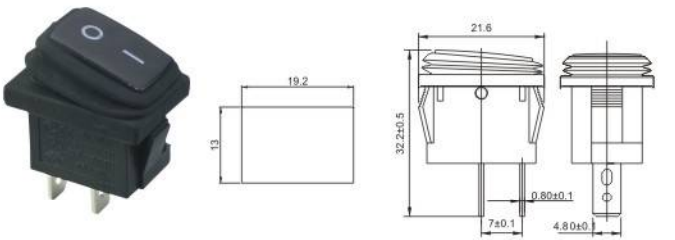

KCD1-2-101W ON-OFF

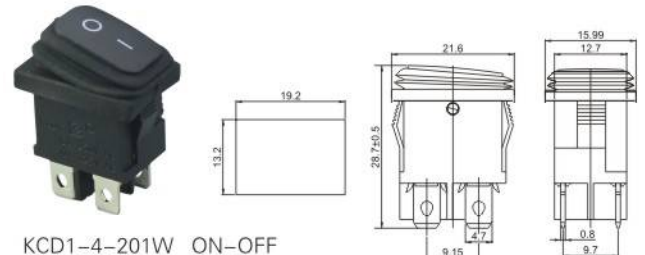

KCD1-4-201W ON-OFF
KCD1-4-201NW ON-OFF

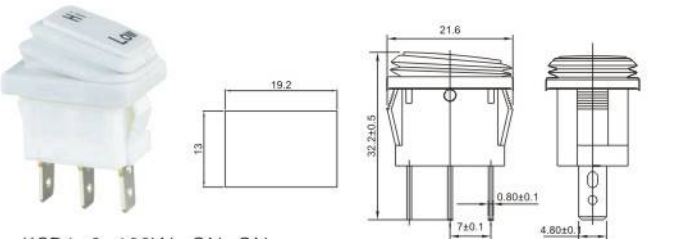

KCD1-2-102W ON-ON
KCD1-2-103W ON-OFF-ON

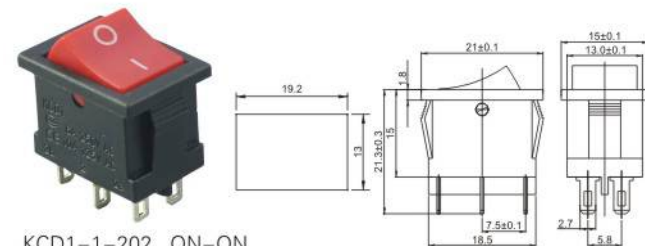

KCD1-1-202 ON-ON
KCD1-1-203 ON-OFF-ON

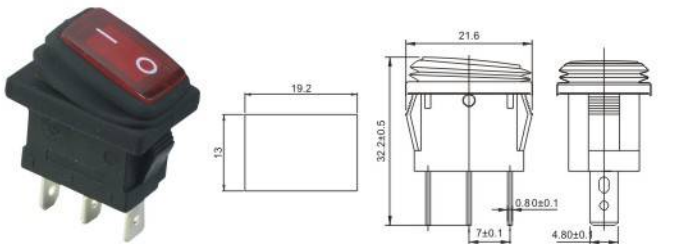

KCD1-2-101NW ON-OFF

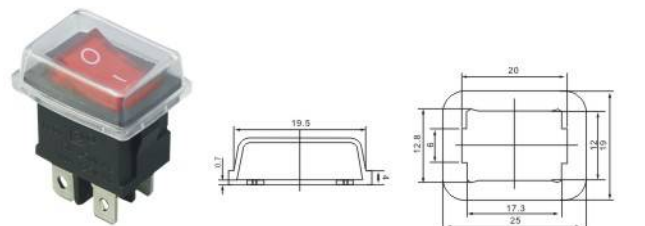

WPC-01

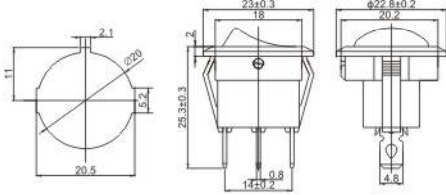

KCD1-8-101N ON-OFF

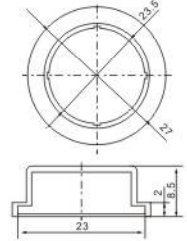

WPC-02

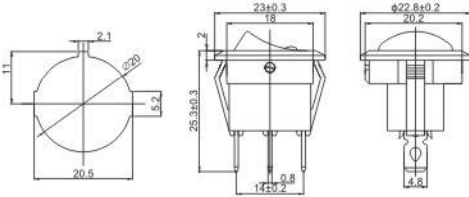

KCD1-8-101EN ON-OFF

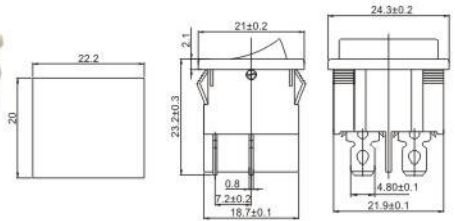

KCD1-6-201 ON-OFF

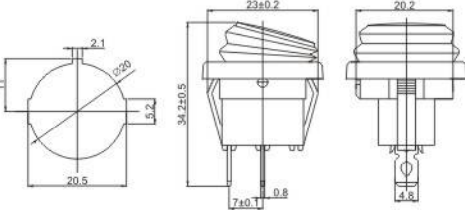

KCD1-8-101W ON-OFF

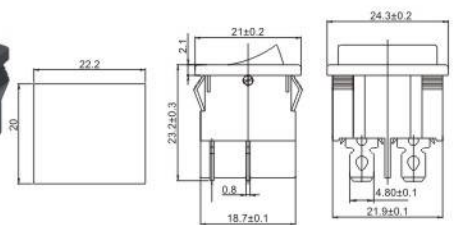

KCD1-6-201N ON-OFF

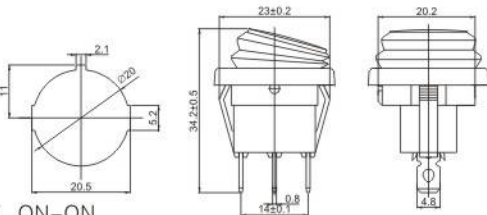

KCD1-8-102W ON-ON
KCD1-8-103W ON-OFF-ON

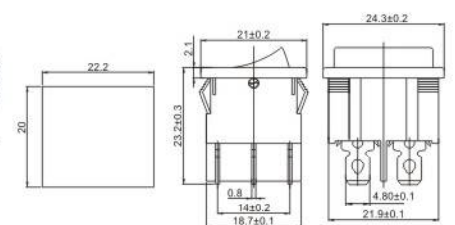

KCD1-6-202 ON-ON
KCD1-6-202N ON-ON KCD1-6-203 ON-OFF-ON

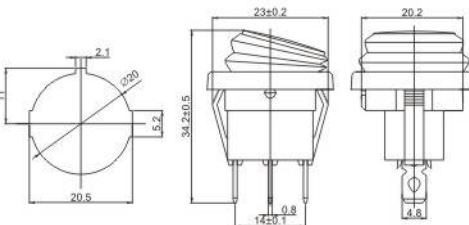

KCD1-8-101NW ON-OFF

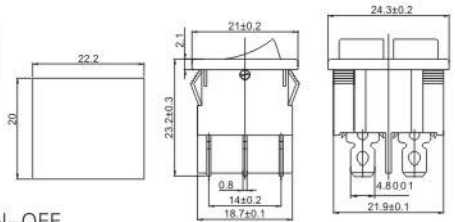

KCD1-6-2101 ON-OFF
KCD1-6-2101N ON-OFF KCD1-6-2102 ON-ON

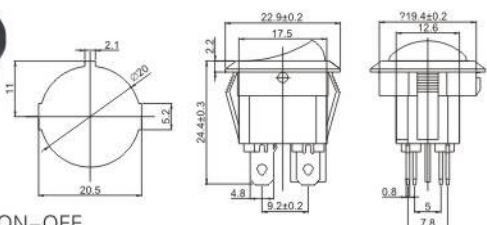

KCD1-8-201 ON-OFF
KCD1-8-201N ON-OFF

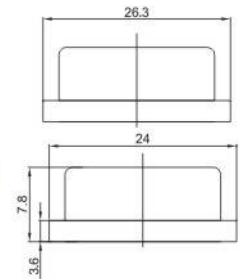

WPC-15

KCD3 Series Rocker Switch

技术特性 Specification

- | | |
|---|---|
| 1. 规格 Rating: 20A 125VAC; 15A 250VAC | 4. 耐电压 Dielectric Strength: 1500VAC, 1 Minute |
| 2. 接触电阻 Contact Resistance: 35mΩ max | 5. 操作温度 Operating Temperature: -25°C~ +85°C |
| 3. 绝缘电阻 Insulation Resistance: 500VDC 100MΩ min | 6. 电气寿命 Electrical Life: ≥10,000 Cycles |

型号说明 Model Information

| | | | | | | | | | | | | | | | | |
|------------|---|----------|---|----------|--|--|---|--|--|--|---|----------|------------------------|-----------------------|----------|------------------|
| KCD | 3 | - | 2 | - | 1 | 01 | N | W | L | - | C3 | - | R | B | - | 220V |
| | 特征 Features | | 序号 Series | | 刀数 Poles | 功能 Function | 带灯状态 Lamp | 按钮类型 Actuator | 端子类型 Terminals | | 标记 Marking | | 按钮颜色 Actuator Color | 外壳颜色 Housing Color | | 灯电压 Lamp Volt |
| | 1 Miniature 2 Medium 2 poles 3 Medium 1 pole 5 Sub-Miniature | | 1 1 pole 1 button 2 2 pole 1 button 21 2 pole 2 button 3 3 pole 1 button 31 3 pole 3 button | | 01 ON-OFF 02 ON-ON 03 ON-OFF-ON 11 (ONI)-OFF(单复位) 12 (ONI)-ON(单复位) 13 (ONI)-OFF-ON(双复位) 23 (ONI)-OFF-ON(双复位) | No Mark No lamp N Lens illuminated EN Dot illuminated No Mark C shape W Waterproof H High Actuator V V shape | No Mark Straight D Short L Right Angle S Screw T Through hole | C1 C2 C3 C4 C5 C6 C7 C8 C9 C10 CX 其他规格 | W 白色White R 红色Red G 绿色Green Y 黄色Yellow BL 蓝色Blue O 橙色Orange GR 灰色Gray C 咖啡色Coffee | W 白色White R 红色Red G 绿色Green Y 黄色Yellow BL 蓝色Blue O 橙色Orange GR 灰色Gray C 咖啡色Coffee | 3V 6V 12V 24V 48V 110V 220V | | | | | |

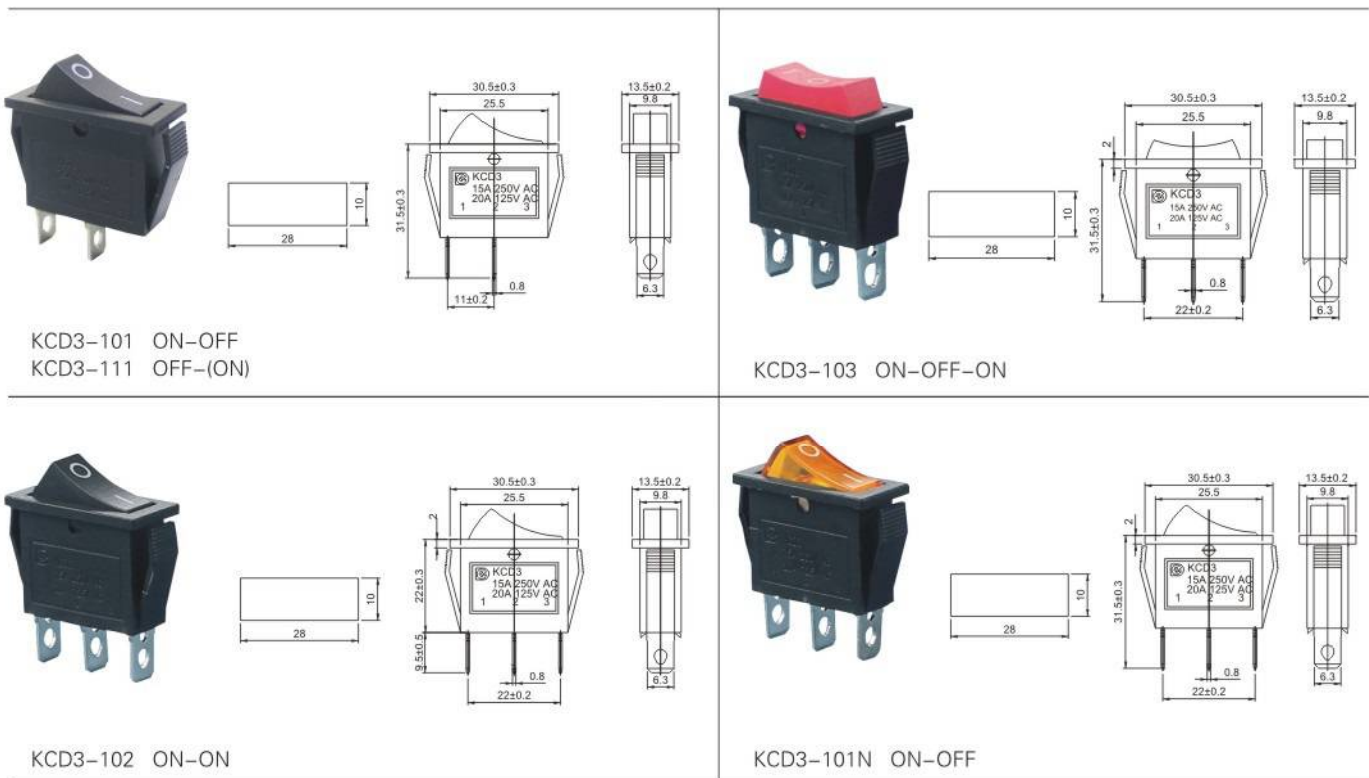

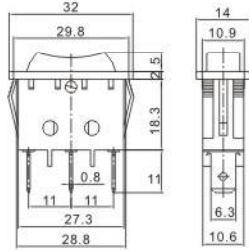
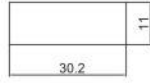

KCD3-4-103 ON-OFF-ON
KCD3-4-123 (ON)-OFF-(ON)

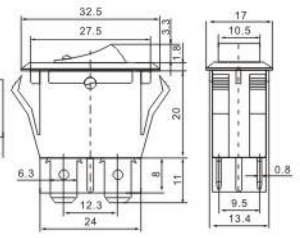

KCD3-11-201EN ON-OFF

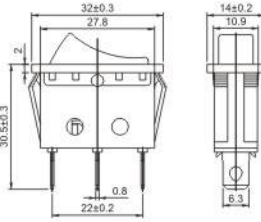
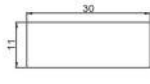

KCD3-4-101N ON-OFF

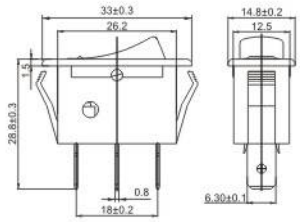

KCD3-12-101N ON-OFF

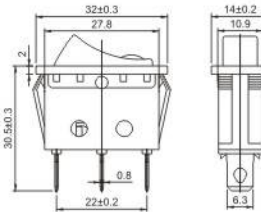
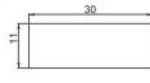

KCD3-4-101EN ON-OFF

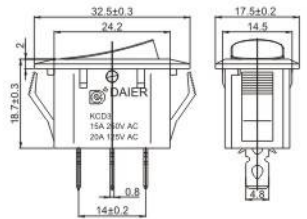
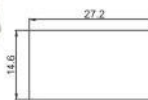

KCD3-18-101N ON-OFF

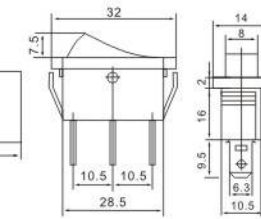

KCD3-5-101N ON-OFF

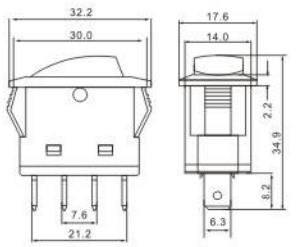

KCD3-14-201N ON-OFF

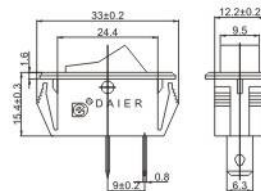

KCD6-101 ON-OFF

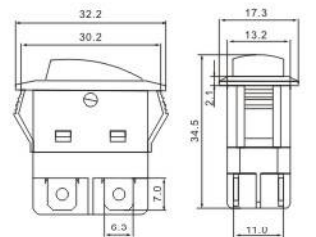
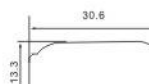

KCD3-14P-201N ON-OFF

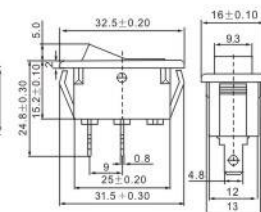

KCD3-8-101 ON-OFF
KCD3-8-102 ON-ON

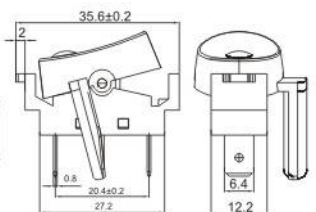
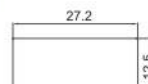

KCD3-17-101EN ON-OFF

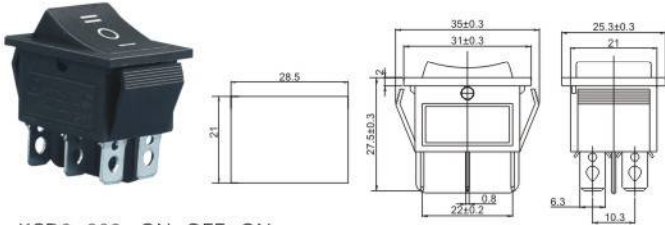

KCD2-203 ON-OFF-ON
KCD2-213 ON-OFF-(ON) KCD2-223 (ON)-OFF-(ON)

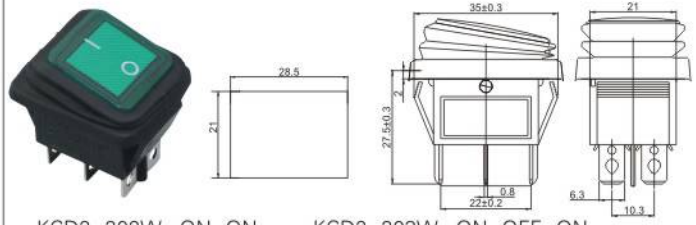

KCD2-202W ON-ON KCD2-203W ON-OFF-ON
KCD2-202NW ON-ON KCD2-203NW ON-OFF-ON

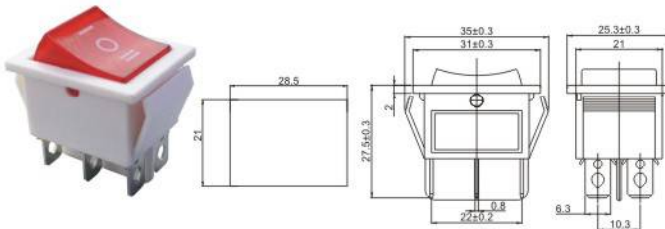

KCD2-203N ON-OFF-ON

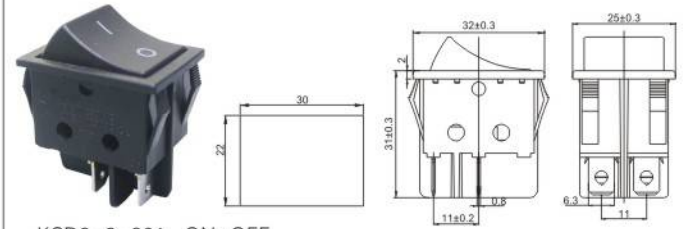

KCD2-2-201 ON-OFF
KCD2-2-211 OFF-(ON)

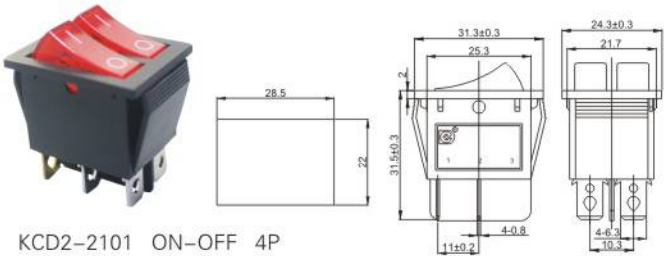

KCD2-2101 ON-OFF 4P
KCD2-2101N ON-OFF 6P

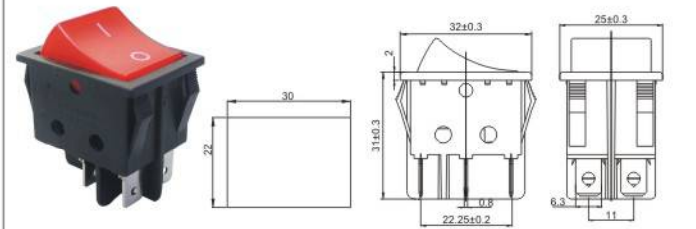

KCD2-2-201N ON-OFF

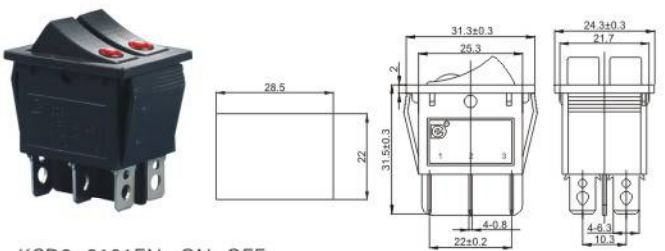

KCD2-2101EN ON-OFF

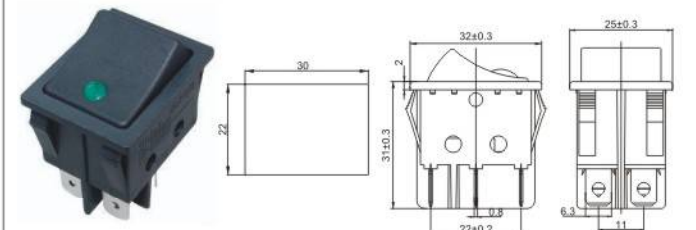

KCD2-2-201EN ON-OFF

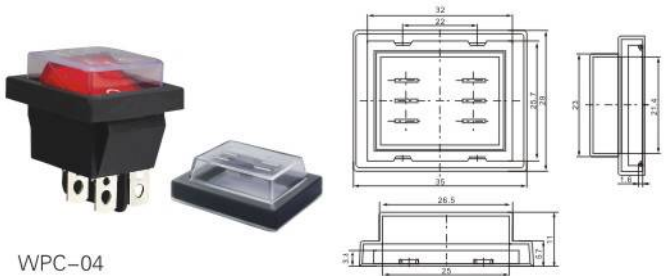

WPC-04

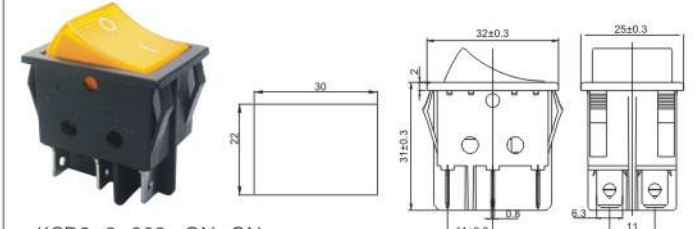

KCD2-2-202 ON-ON
KCD2-2-202N ON-ON

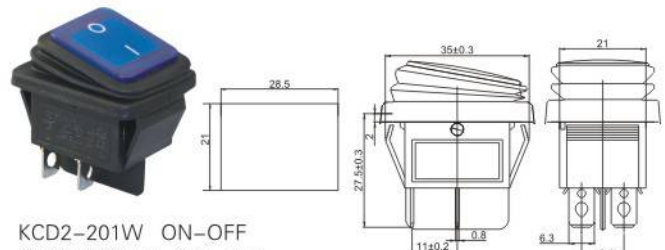

KCD2-201W ON-OFF
KCD2-201NW ON-OFF

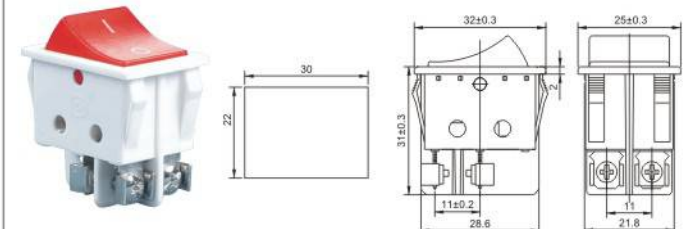

KCD2-2-201NS ON-OFF