

RT18-125

Low voltage AC fuse



Application

This series fuse is mainly used for protecting the electrical circuit against overload and short-circuits(gG/gL). Because of different melting tablets, it also may derive for protecting the semiconductor device and others complete set installment from short-circuit (aR/gR/gS/gtr) as well as the electric motor from short-circuit (aM).

Structural Characteristics

- According to IEC60269-6
- Rated current: 1-125A
- Rated voltage: AC 380V/500V
- Cylindrical fuse

Specification

Pole	1P,2P,3P
Rated Voltage Ue (V AC)	380V/500V
Rated Current In (A)	1, 2, 3, 4, 5, 6, 8, 10, 12,16, 20, 25, 32,40,50,63,80,100,125
Biggest Block Ability(KA)	100

Connection and Installation

Working Temperature(°C)	-5~+40
Resistance And Damp Hot	Class 2
Altitude(m)	≤ 2000
Relative Humidity	≤ 95%
Protection Class/Degree	IP20
Pollution	3
Installation Environment	No obvious shock and vibration
Installation Class/Type	Class III/DIN rail

Size(mm)

W*H*L	36x76x120
Fuse Size	22x58

Dimensions(mm)

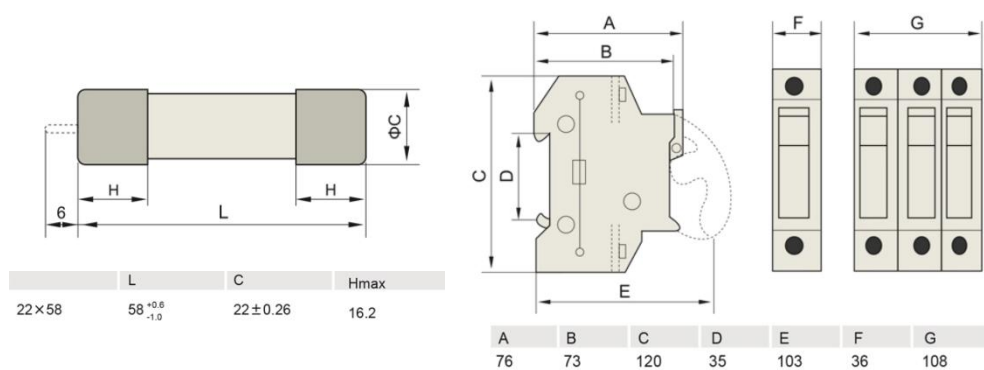

Installation

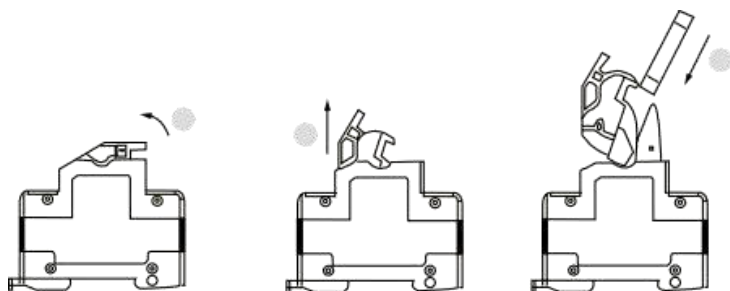

Characteristic Curve

